

MODEL : MIKOTOS (WITH SIDE PANEL)

INSTALLATION INSTRUCTIONS

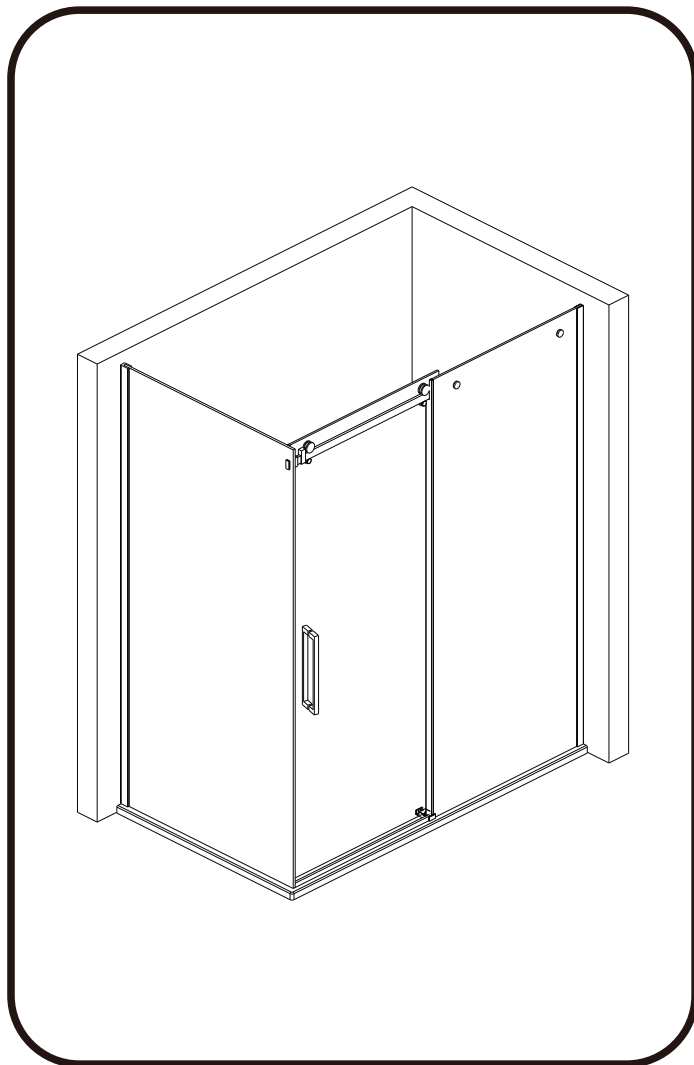

Tools Required



Drill



6mm Masonry Drill
3.2mm HSS Drill

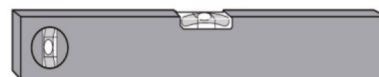

Spirit level



Sealant Gun

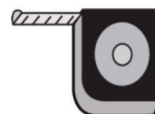

Tape Measure



Pencil



**PH2 TYPE
Screwdriver**

Please not hand tools NOT supplied.

IMPORTANT

These instructions assume that installation is done against solid/tiled walls.

The wall plugs supplied with the installation kit are for use on solid walls. Hollow or stud-partition walls will require alternative fixings. Please consult with a reputable trades person or hardware supplier for the correct type of fixing.

It may also be necessary to consult your tiling supplier about the correct method drilling your tiles.



MODEL : MIKOTOS (WITH SIDE PANEL)

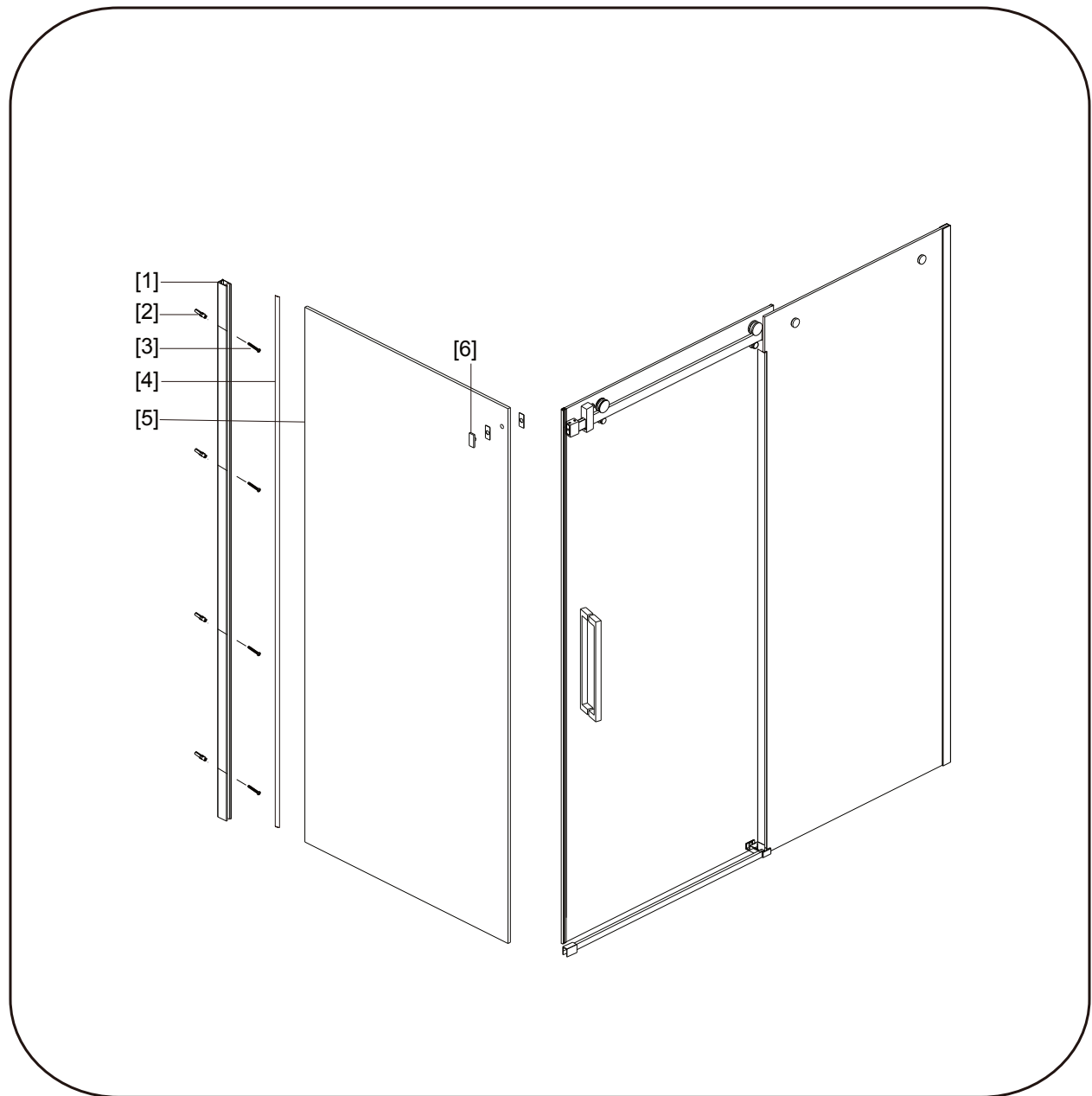

NO.	Description	Qty
1	Wall Profile	1
2	Wall Anchor	4
3	Round Screw M4x30	4
4	T Shaped Seal	1
5	Side Panel Glass	1
6	Side Panel Rail Bracket	1



INSTALLATION STEPS

Step 1

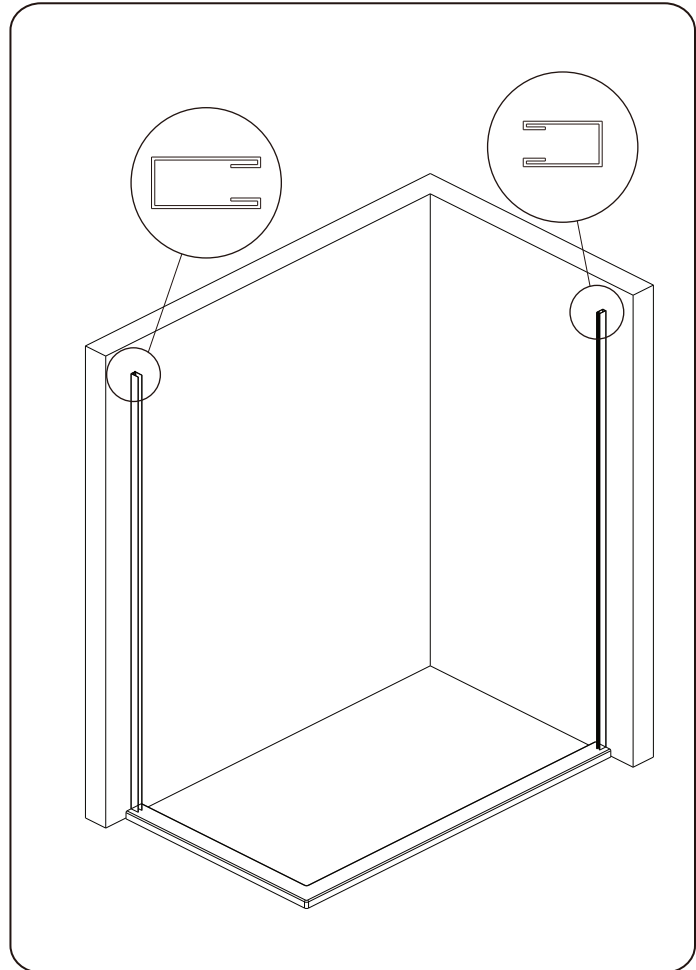
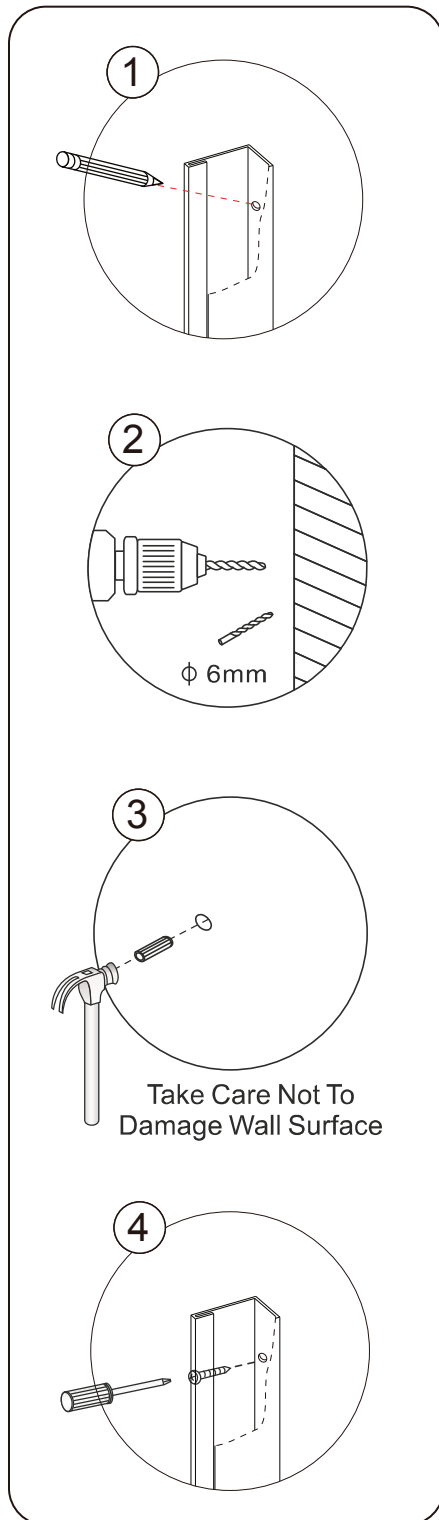

MODEL : MIKOTOS (WITH SIDE PANEL)

Step 2

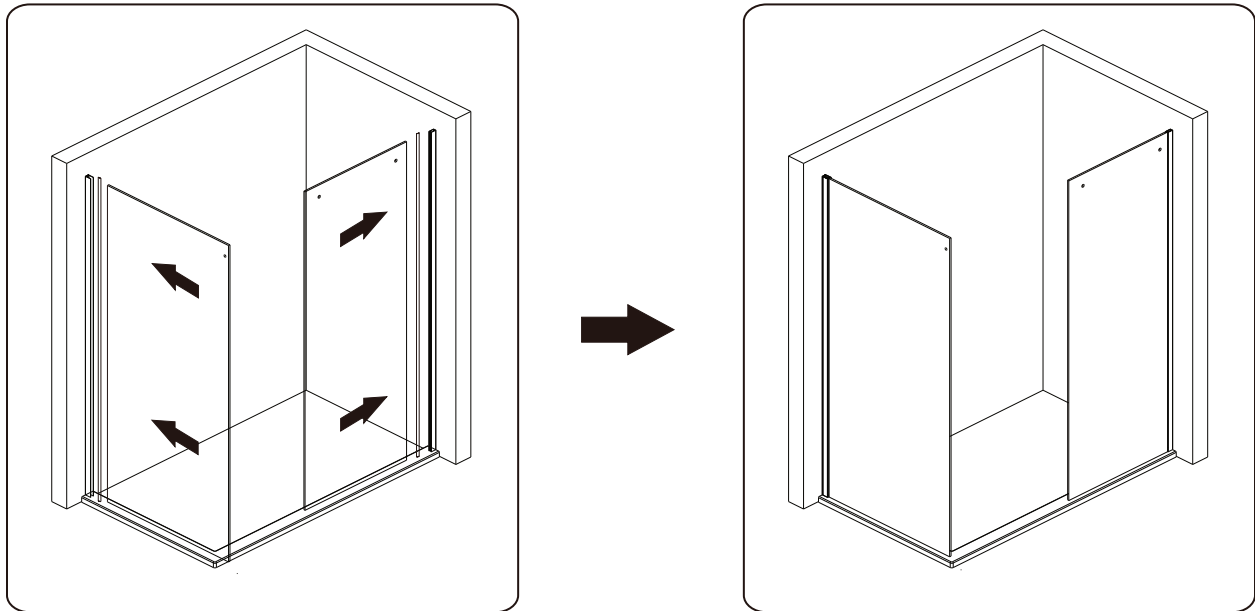

Step 3

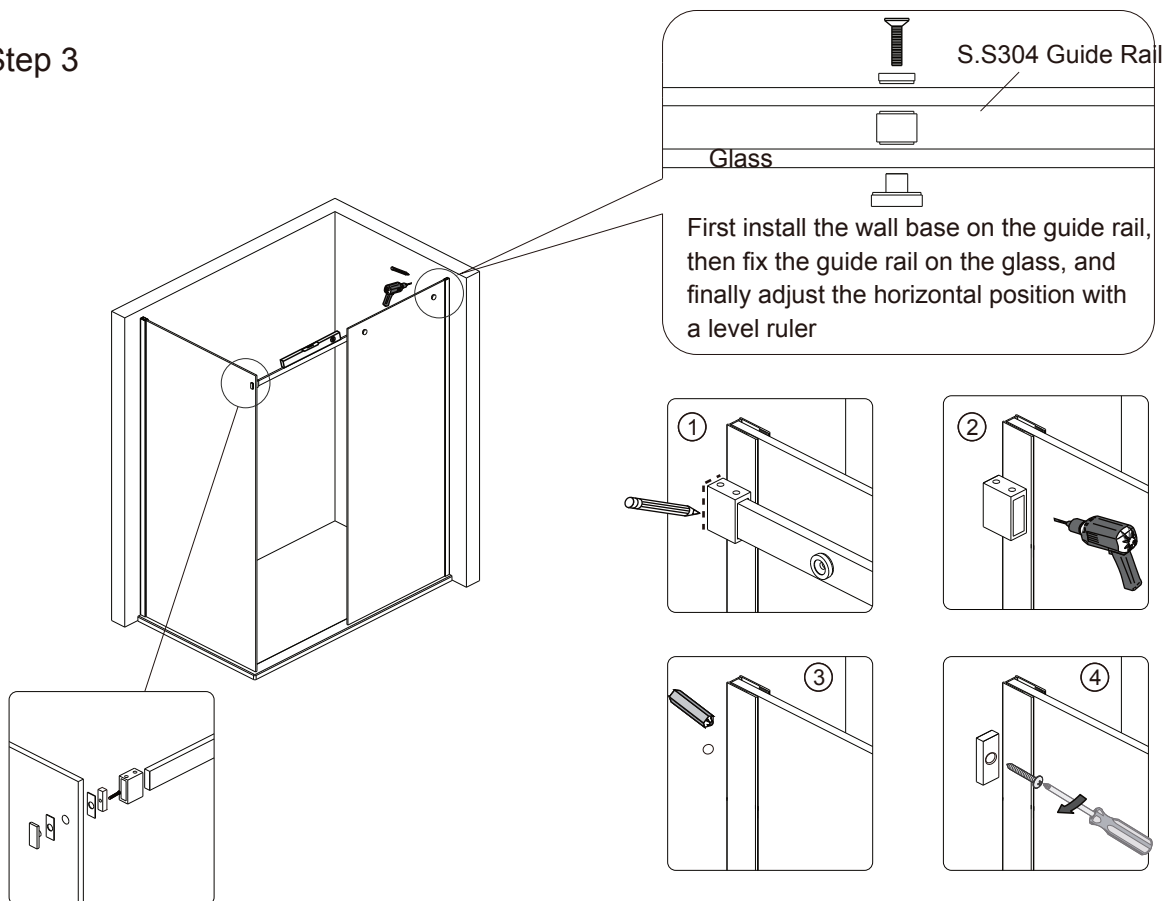

MODEL : MIKOTOS (WITH SIDE PANEL)

Step 4

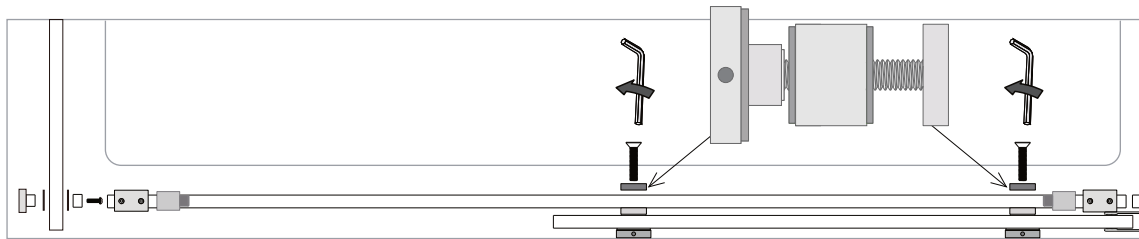

Install the anti-collision block onto the guide rail first,
and then lock the guide rail and wall base tightly

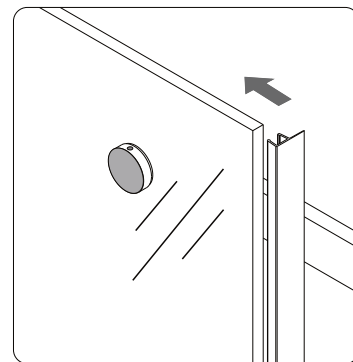
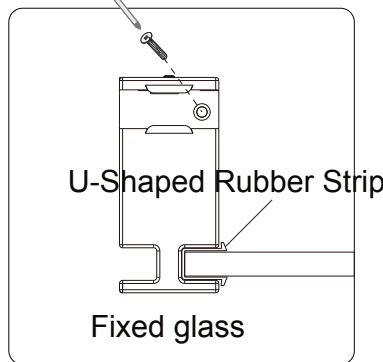
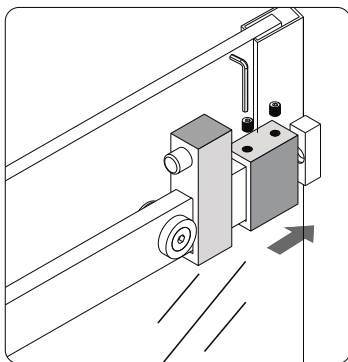

Step 5

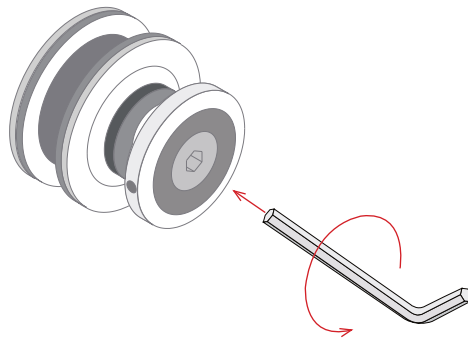

Disassemble the pulley and
install it on the glass

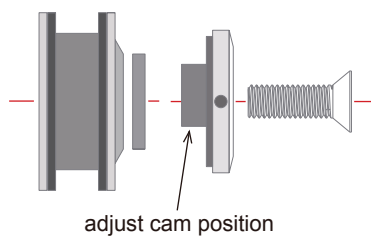

Cam position down=glass down

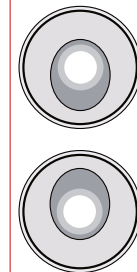

Cam position upwards=glass rises upwards



MODEL : MIKOTOS (WITH SIDE PANEL)

Step 6

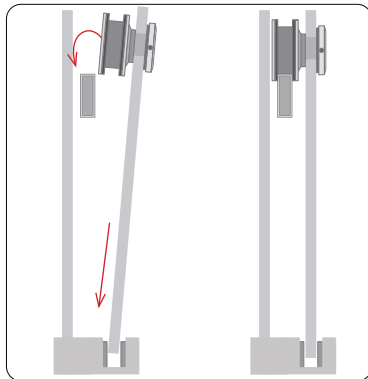

Hang the door glass on the guide rail.

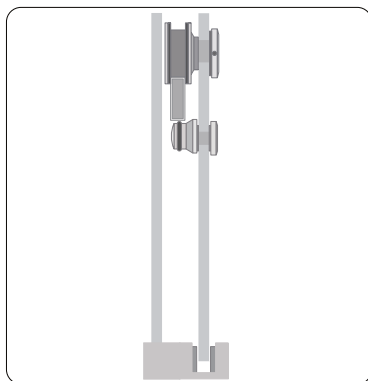
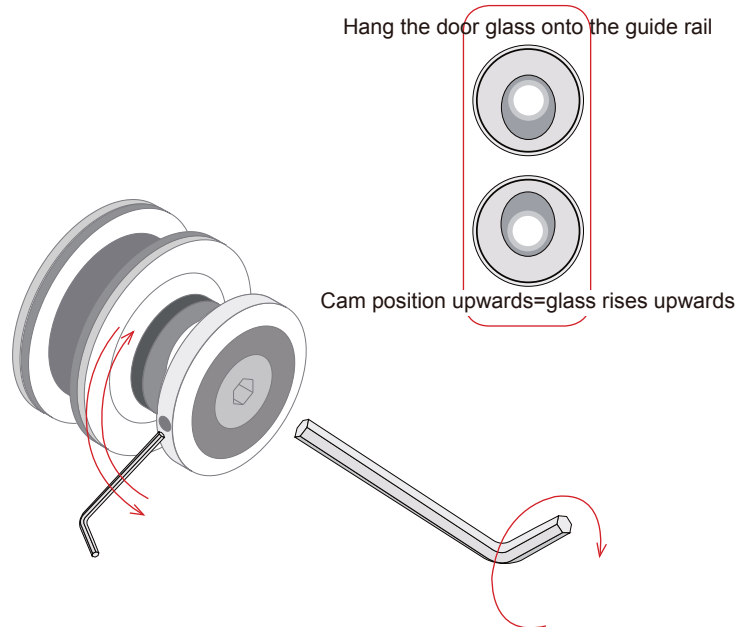

Install anti jump components

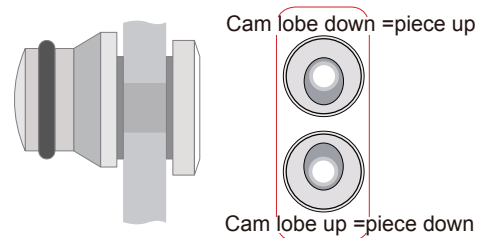
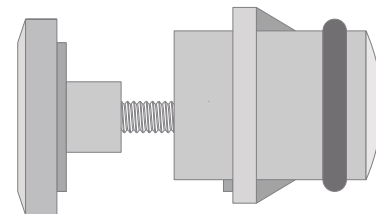

MODEL : MIKOTOS (WITH SIDE PANEL)

Step 7

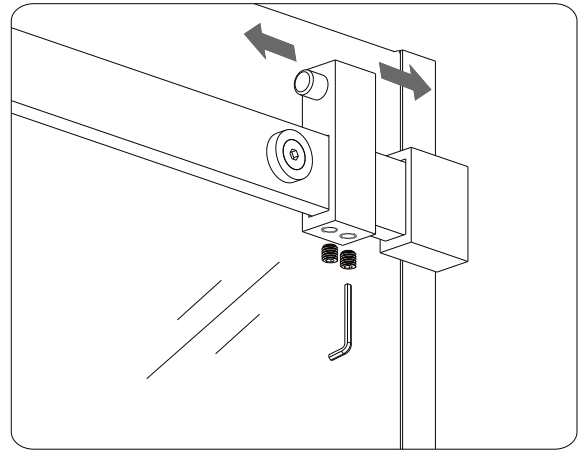
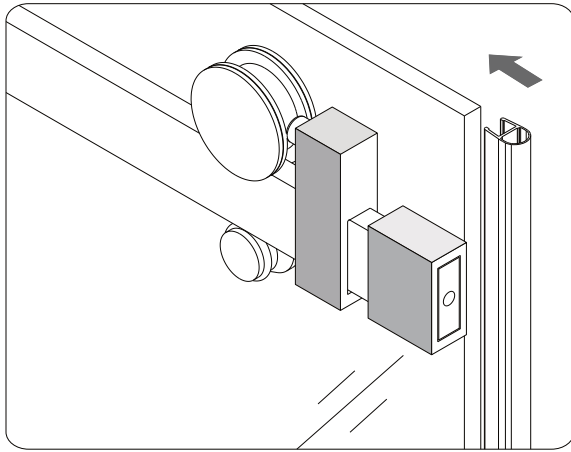

Step 8

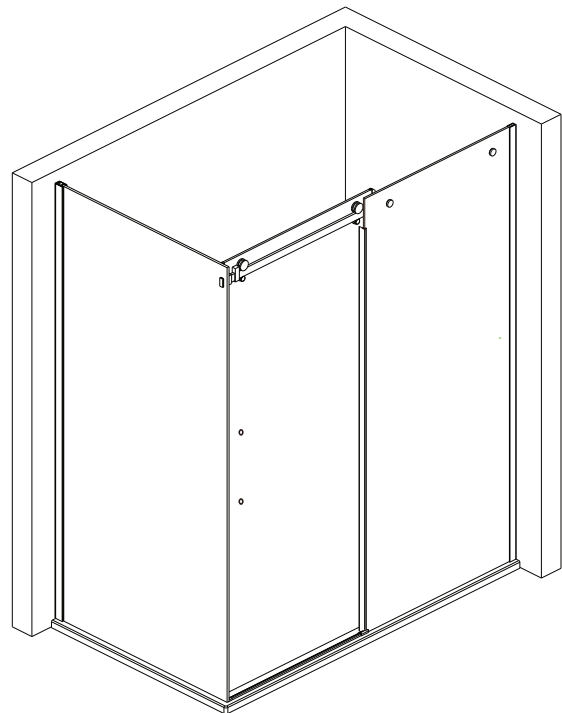
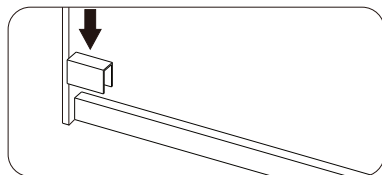
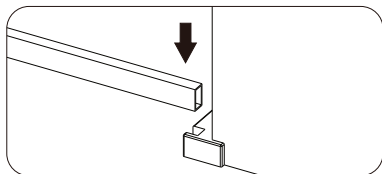
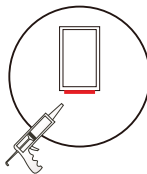
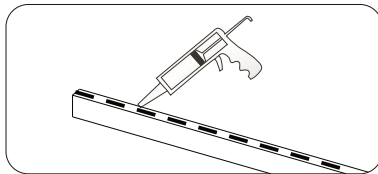

MODEL : MIKOTOS (WITH SIDE PANEL)

Step 9

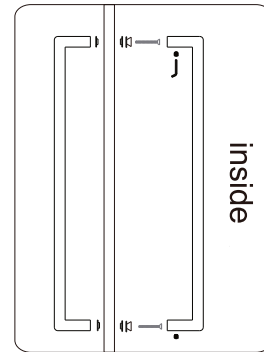
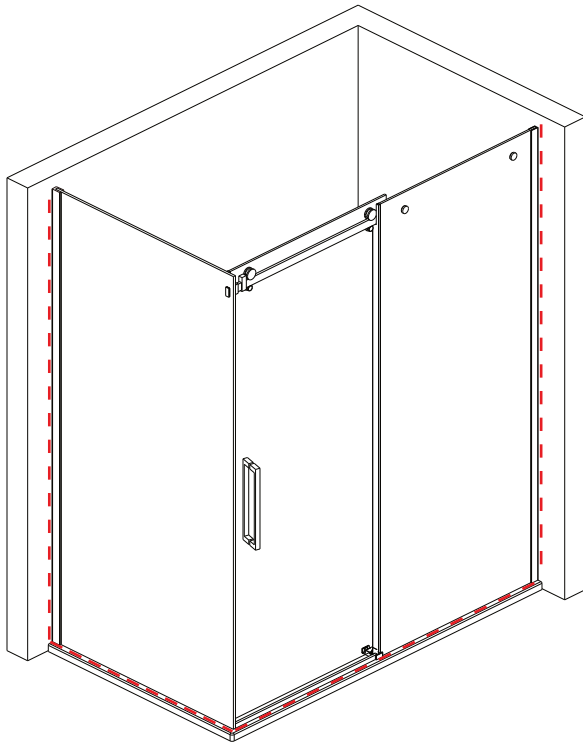

Allow 24 hours for silicone to dry before use.

Silicone on the outside edge only

