

BATHROOM MIRROR INSTALLATION

Before starting your installation, please make sure:

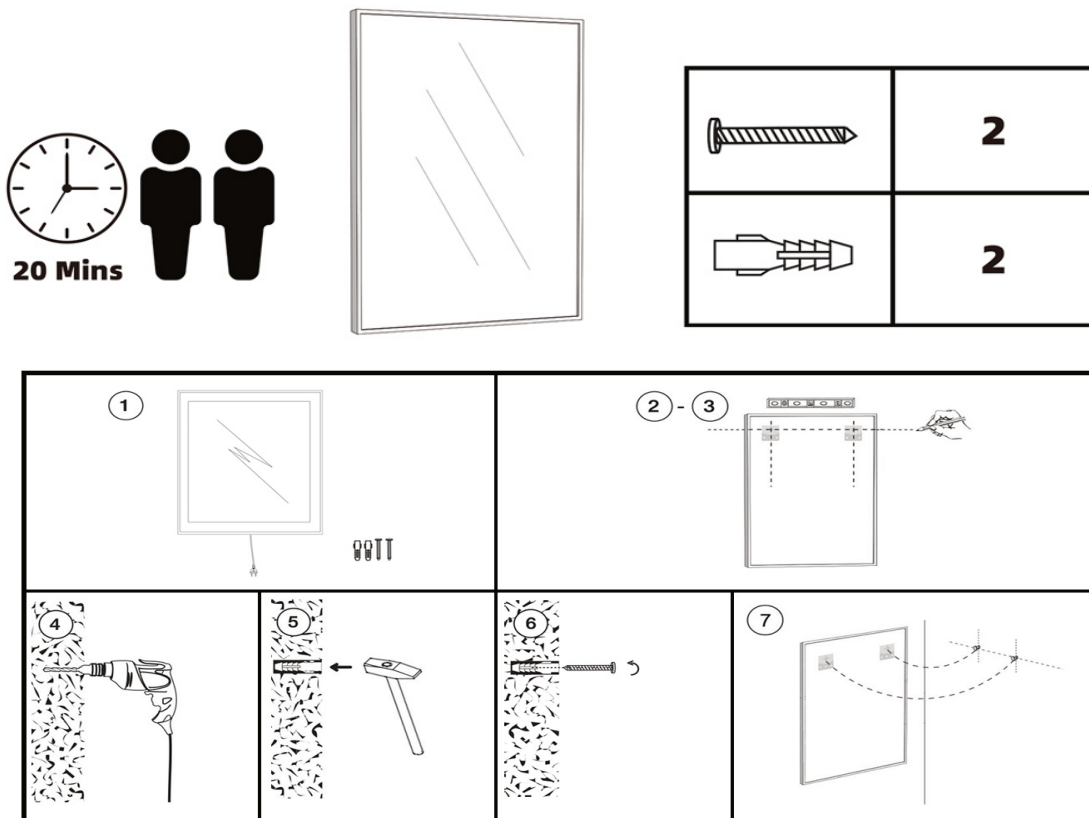

1. Measure the distance between the key-hole centers on the back of the mirror.

2-3. Draw a horizontal line on the wall according to the height at which you want to hang the mirror and mark the hole positions on the wall with a pencil, using the dimension taken from step 1.

4. Drill the hole with a percussion drill, using the hole positions from step 2-3. Ensure that the hole positions are horizontal.

5. Use a hammer to nail the expansion bolt plug into the hole and keep it level with the wall.

Note: The expansion bolt plugs supplied are only suitable for solid stone/brick walls. For any other wall types, please go to the store to buy the correct plugs and screws after checking.

6. Use a screwdriver to tighten the screw into the expansion bolt, leaving approximately 5-10mm of the screw standing proud of the wall.

7. Hang the mirror onto the screws fitted to the wall. Ensure the mirror is securely mounted.

